

Date	Rev. date	Work nr.	Drw. nr.	Rev.
Drawn by Ruukki	Rev.	M30/S32	-	
Scale 1:2	Building	File nr. P2001/003-00040		

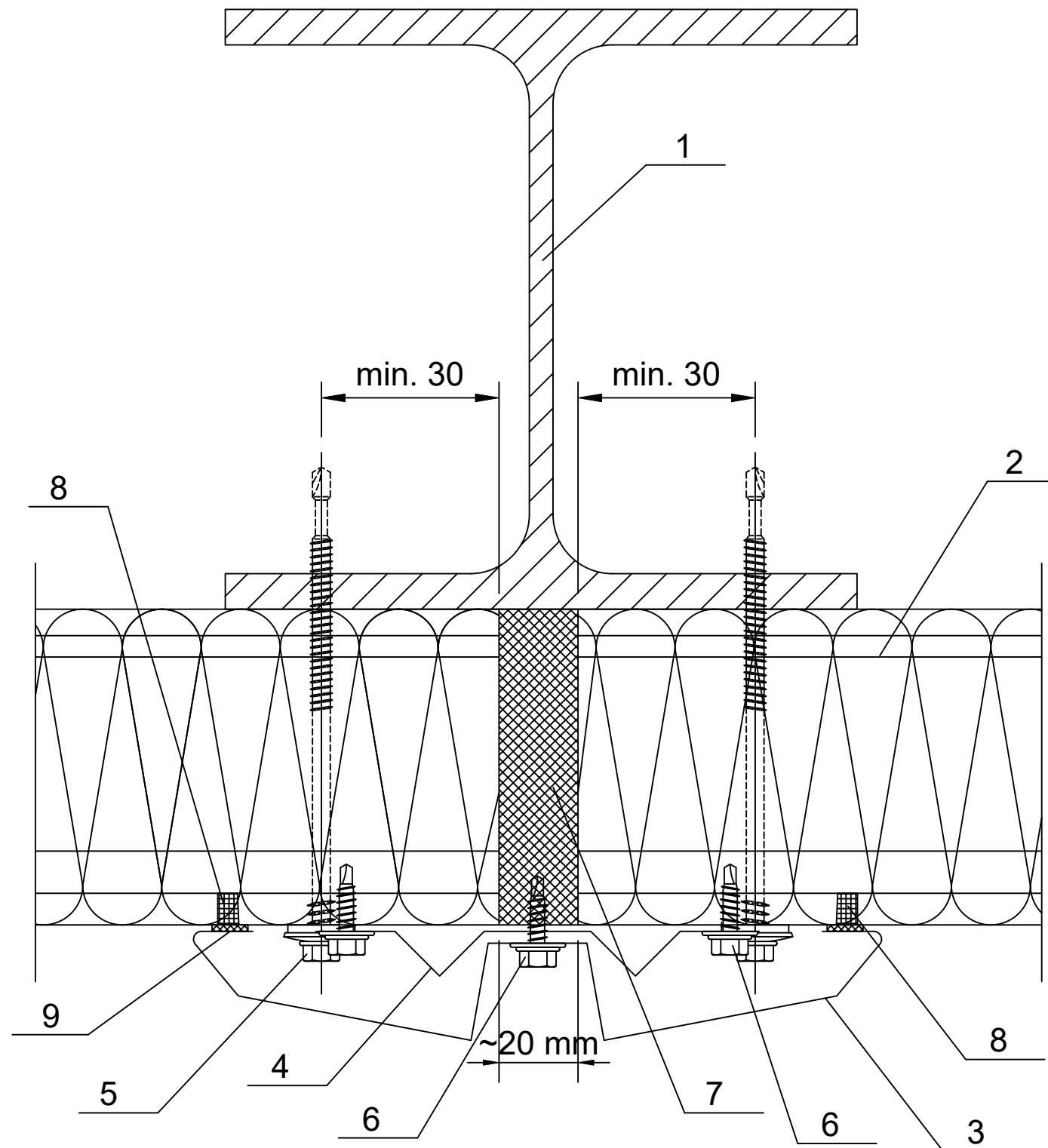

1. Steel column acc. to engineering design of the structure
2. Ruukki SP2D PIR
3. EA1B40 joint flashing (max. length of 3000 mm)
4. EA1B41 assembly flashing (L=100 mm, every 300 mm)
5. Panel fastener for hot-rolled sheeting rail or for cold-bent sheeting rail
6. L03 fastener
7. Impregnated polyurethane sealant or expanded foam
8. Permanently elastic sealing compound in panel joint
9. 4x10 PIR self-adhesive sealant